

F3 F4 нагреваемая сторона: F3 вход, F4 выход

F1 F2 греющая сторона: F1 вход, F2 выход

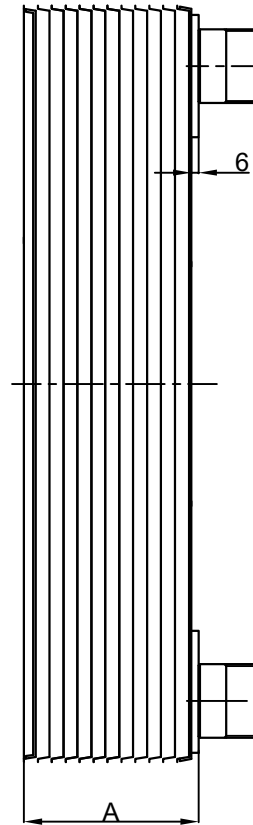

G2" Connection(L023)

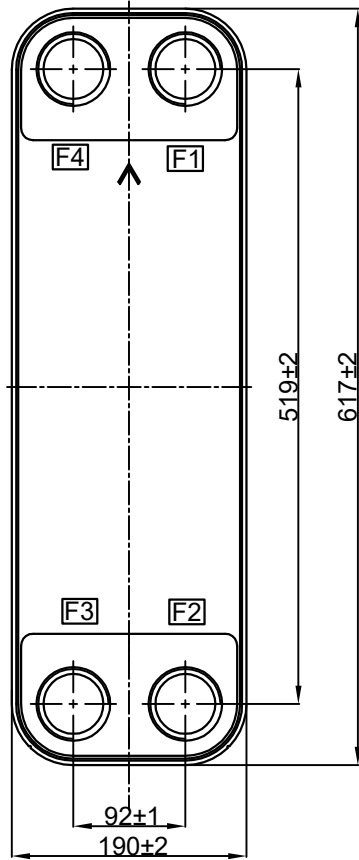
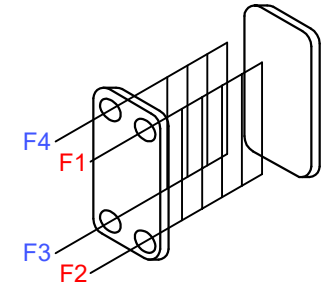
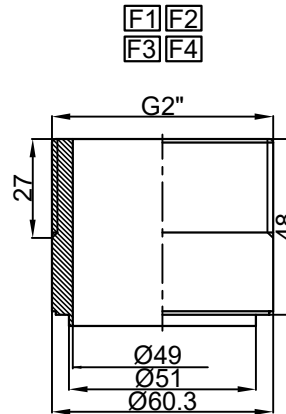

Design pressure(MPa)	4.5
Testing pressure(MPa)	6.7
Design Temperature(°C)	-196~+200°C
Label Code	

Model	Height (mm)	Tube Length (mm)	F1/F2 Side Area (m²)	F3/F4 Side Area (m²)	Volume (L)	Weight (kg)	Heat Transfer Area (m²)
FHT5433-071	150	372±8	F1F2side:15.75 ;F3F4side:15.54		65.70	14.06	
FHT5433-070	140	348±5	F1F2side:14.70 ;F3F4side:14.49		61.80	13.11	
FHT5433-069	130	325±5	F1F2side:13.65 ;F3F4side:13.44		57.90	12.16	
FHT5433-068	120	301±5	F1F2side:12.60 ;F3F4side:12.39		54.00	11.21	
FHT5433-067	110	278±5	F1F2side:11.50 ;F3F4side:11.34		50.10	10.26	
FHT5433-066	100	254±5	F1F2side:10.50 ;F3F4side:10.29		46.20	9.31	
FHT5433-065	90	230±3	F1F2side:9.45 ;F3F4side:9.24		42.30	8.36	
FHT5433-064	80	207±3	F1F2side:8.40 ;F3F4side:8.19		38.40	7.41	
FHT5433-063	70	183±3	F1F2side:7.35 ;F3F4side:7.14		34.50	6.46	
FHT5433-062	60	160±3	F1F2side:6.30 ;F3F4side:6.09		30.60	5.51	
FHT5433-061	50	136±3	F1F2side:5.25 ;F3F4side:5.04		26.70	4.56	
FHT5433-060	40	112±2	F1F2side:4.20 ;F3F4side:3.99		22.80	3.61	
FHT5433-059	30	89±2	F1F2side:3.15 ;F3F4side:2.94		18.90	2.66	
Drawing No.	Customer Part No.	Plate No.	A(mm)	Volume(L)	Weight (kg)	Heat transfer area(m²)	

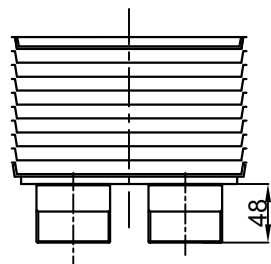

Connection vertical degree: ±2°						Plate material: 316L	
						Connection material: 304	
						Cover plate material: 304	
						SNB095-N-4.5-H F1F2F3F4(G2")	
Mark No.	Change file No	sign	Date	View	Scale		
Design	XUZH	Standard					
Check		Approved					
Review		Edition	A/0				
Process		Date	20220427		1:6		